



The Mizoram Gazette

EXTRA ORDINARY

Published by Authority

RNI No. 27009/1973

Postal Regn. No. NE-313(MZ) 2006-2008

VOL - XLIV Aizawl, Wednesday 14.1.2015 Pausa 24, S.E. 1936, Issue No. 11

NOTIFICATION

No.K.15012/12/2010-REV, the 3rd December, 2014. Whereas the Environment & Forest Department has surrendered 550 ha of Riverine Forest land for the purpose of construction of 460 M.W. Kolodyne Hydro Power Project under the Forest (Conservation) Act, 1960.

And; whereas 550 ha of Land at different locations has to be assigned to the Environment & Forest Department, Government of Mizoram as compensatory afforestation.

And; whereas the land has been already earmarked

Now, Therefore, the Government of Mizoram is pleased to notify that the land as specified below are assigned to the Environment & Forest Department for the purpose of afforestation in accordance with the provision of Section 18 (1) of the Mizoram (Land Revenue) Rules, 2013.

Location & name of Village		District	Area in Hac	Map of Site plan	Description of boundary
1		2	3	4	5
1.	Lamthumthum lui leh Darthlak lui inkar South Phaileng V.C.	Lunglei	100	As per Annexure A	As per Annexure B
2.	Tlawng lui kam, Vuakdup leh Tlangnuam lui inkar. Chengpui V.C.	Lunglei	300		
3.	Leiten ram, Saipui lui kam Uikhinga lui leh Leiten lui inkar. Mausen V.C.	Lunglei	100		
4.	Pakunga hmun kham hnuai, Tlangkhang kawng hmar lam, South Vanlaiphai V.C.		50		
TOTAL			550		

Zothankhuma,
Secretary to the Government of Mizoram,
Revenue Department.

**BOUNDARY DESCRIPTION OF COMPENSATORY AFFORESTATION
FOR 460MW KOLODYNE HYDRO POWER PROJECT AT
SOUTH PHAILENG : LUNGLEI DISTRICT**

- LOCATION : South Phaileng VC area Mat lui kam, lamthuamthum tlang hnuai.
Lalthuamthum lui leh Darthlak lui inkar.
- ST.POINT : A area hmarthlang lam kil Lamthuamthum luikawr atanga 10.00m a hla Zuang thing bulah BP.No.1 na phun a ni a, teh tan nan hman a ni.
- BP.No.1-3 : BP.No. 1 na atangin kawrkam zelah 86° in a chhuk a, 700.00m Sd,593.63m Hd pt ah BP.2 na phun a ni. BP.No.2 na atangin 93° in a kal leh a 800.00m Sd, 692.82m Hd pt ah BP.No.3 na phun leh a ni.
- BP.No.3-4 : BP.No.3 na atangin Mat luikam ah 165° in a kal leh a, 780.00m pt ah BP.No.4 na phun leh a ni.
- BP.No.4-6 : BP.No.4 na atangin 267° in akal leh a, 750.00m Sd, 649.50m Hd pt ah BP.No.5 na phun leh a ni. BP.No.5 na atang chuan 258° in a kal leh a, 800.00m Sd, 685.73m Hd pt ah BP.No.6 na phun leh a ni.
- BP.No.6-1 : BP.No.6 na atangin ram tha chinah 345° in a kal leh a, 400.00m pt ah BP.No.7 na phun leh a ni. BP.No.7 na atangin 355° in a kal leh a, 500.00m pt ah teh tanna a man leh a ni.

A area chu 1014275.00 Sqmt = 10913599.00 Sqft = 757.88 Bigha = 101.42 Ha a ni.

Demarcated by K.Lalmachhuana Surveyor Land Revenue & Settlement Lunglei District : Lunglei	Checked by K.Lalchhandama Surveyor - I Land Revenue & Settlement Lunglei District : Lunglei	Countersigned by Lalthansياما Asst. Survey Officer Land Revenue & Settlement Lunglei : Mizoram.	Approved by
--	---	---	-------------

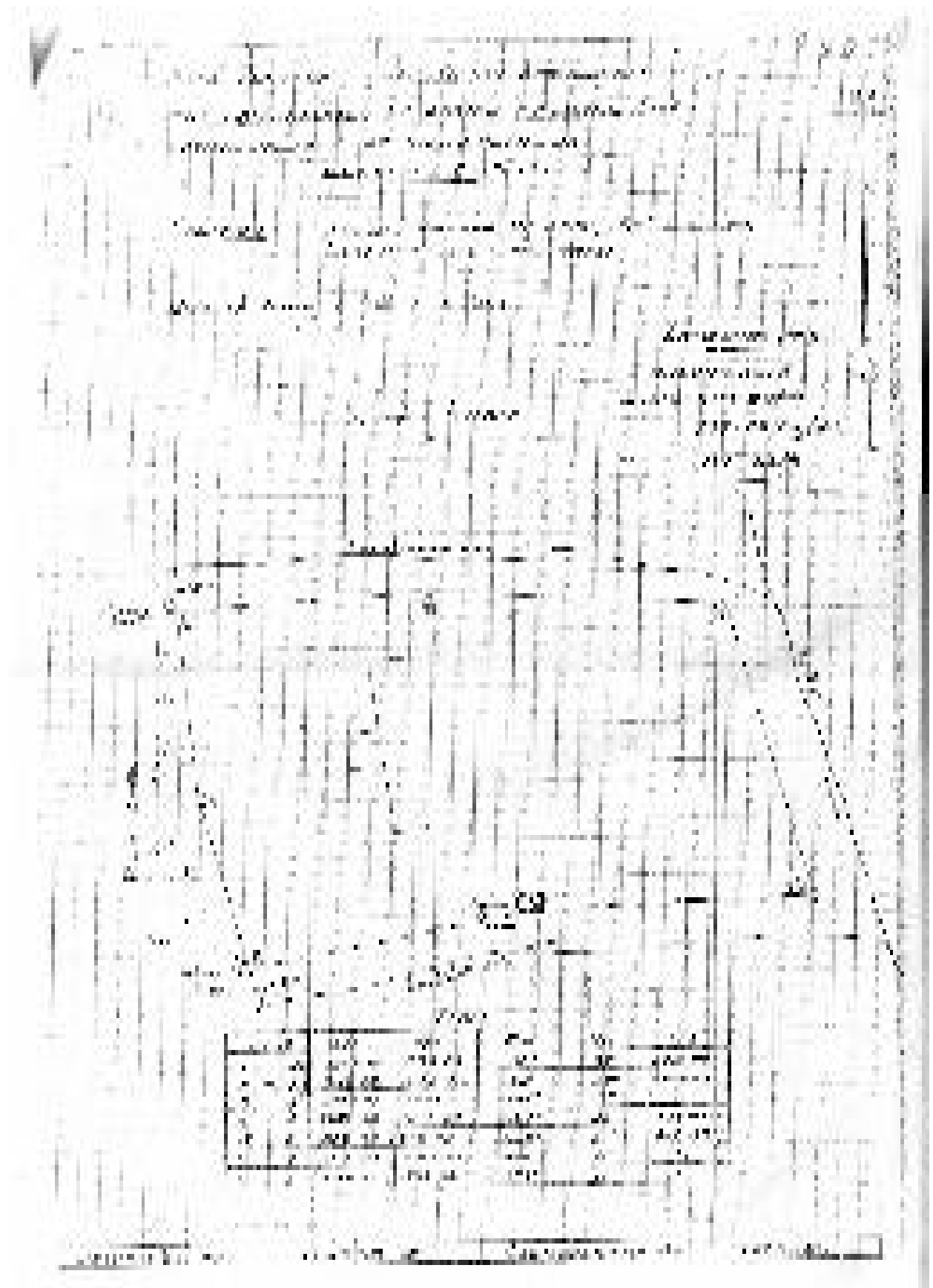

**BOUNDARY DESCRIPTION OF COMPENSATORY AFFORESTATION
FOR 460MW KOLODYNE HYDRO POWER PROJECT AT
CHENGPUI : LUNGLEI DISTRICT**

LOCATION : Lunglei District Chengpui VC area Vaikawng hnuai Tlawng lui kam Vuakdup lui leh Tlawngnuam lui inkar.

ST.POINT : A ram hmar chhak lam kil, Vai kawng hrul Tlawngnuam lui kawr atanga 10.00m a hla ah P.No. 1 na phun a ni a, teh tan nan hman nghal a ni.

P.No.1-4 : Teh tanna sawi atangin Vaikawng hrulah 172° in a kal a, 500.00m pt ah P.No. 2 na phun a ni. P.No.2 na atangin 179° in a kal leh a 700.00m pt ah P.No.3 na phun leh a ni. P.No.3 na atangin 188° in a kal leh a, 650.00m pt ah P.No.4 na phun leh a ni.

P.No.4-7 : P.No.4 na atangin ramri chu Vuakdup lui 10.00m zela hlat in 281° in a kal leh a, 650.00m Sd, 589.10m Hd pt ah P.No.5 na phun leh a ni. P.No.5 na atangin 267° in a kal leh a, 750.00m Sd, 695.32m Hd pt ah P.No.6 na phun leh a ni. P.No.6 na atang chuan 279° in Tlawng lui thlengin a kal leh a, 500.00m Sd, 433.01m Hd pt ah P.No.7 na phun leh nghal a ni.

P.No.7-10 : P.No.7 na atangin Tlawnglui kam hrulah 354° in a kal leh a, 600.00m pt ah P.No.8 na phun a ni. P.No.8 na atangin 347° in a kal leh a, 600.00m pt ah P.No.9 na phun leh a ni. P.No.9 na atangin 07° in a kal leh a, 500.00m pt ah Tlawng lui leh Tlawngnuam lui infinna ah P.No.10 na phun nghal a ni.

P.No.10-1 : P.No.10 na atangin 92° in Tlawngnuam lui kam hrulah 800.00m Sd, 678.43m Hd pt ah P.No.11 na phun leh a ni. P.No.11 na atangin 83° in a kal leh a, 700.00m Sd, 573.40m Hd pt ah P.No.12 na phun leh a ni. P.No.12 na atangin 91° in a kal leh a, 750.00m Sd, 629.00m Hd pt ah a tira teh tanna P.No.1 na kha a man leh a ni.

A area pumpui chu 3017500.00 Sqmt= 32468300.00 Sqft = 2254.74 Bigha = 301.75 Ha a ni.

Demarcated by	Checked by	Countersigned by	Approved by
K.Lalmachhuana	K.Lalchhandama	Lalthansiamama	
Surveyor	Surveyor - I	Asst. Survey Officer	
Land Revenue & Settlement	Land Revenue & Settlement	Land Revenue & Settlement	
Lunglei District : Lunglei	Lunglei District : Lunglei	Lunglei : Mizoram.	

(8) 482

SITE PLAN OF COMPENSATORY AFFORESTATION FOR CONSTRUCTION OF 450 MW. HYDRO POWER PROJECT AT CHENGPOI VILLAGE LUNGLEI DISTRICT.

LOCATION: CHENGPOI V.C. AREA, YAI KAWNE HALLAI, TLAWING LUY KAN, VUAKDUP LUI, KAWR LEH, TAWNGNDAM LUY INKAR.

Date of Survey: 6.12.2013

DEMARCATED AREA:

SCALE 1:2000

3017500.00 Sqm.

= 32468300.00 Sqft.

= 2254.74 Bighas.

= 301.75 Ha.

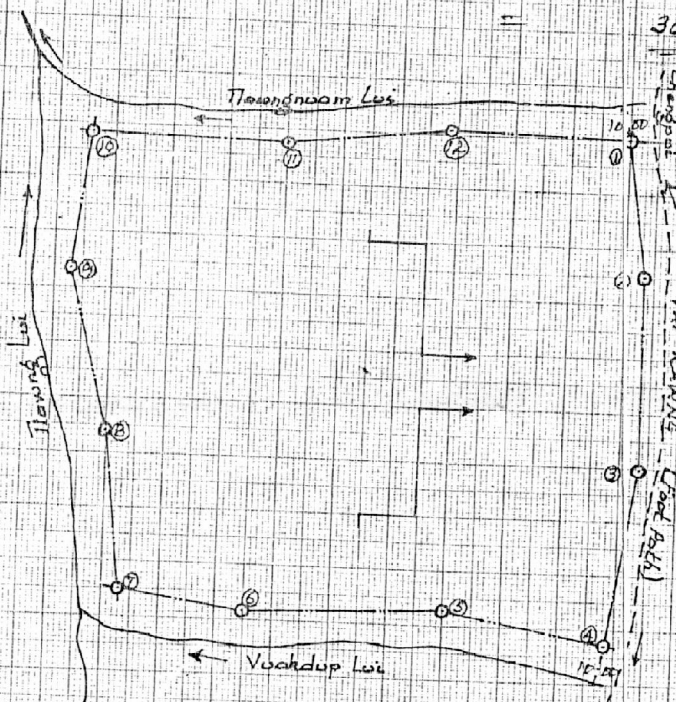

TABLE:

LINE	S/D	H/D	F/B	V/A	V/D
1 - 2	600.00	500.00	172°	0'	X
2 - 3	700.00	700.00	179°	0'	X
3 - 4	650.00	650.00	188°	0'	X
4 - 5	650.00	582.10	281°	25°	274.70
5 - 6	750.00	695.32	267°	22°	360.95
6 - 7	500.00	433.01	279°	30°	250.00
7 - 8	600.00	600.00	354°	0'	X
8 - 9	600.00	600.00	347°	0'	X
9 - 10	500.00	500.00	07°	0'	X
10 - 11	800.00	678.43	92°	32°	423.93
11 - 12	700.00	573.49	83°	35°	401.50
12 - 1	750.00	629.00	91°	35°	408.47

DEMARCATED BY

 (K. LALCHANDAMMA)
 Land Revenue & Settlement
 Lunglei District, Lunglei

COUNTERS

 (K. LALCHANDAMMA)
 Asst Surveyor
 Land Revenue
 Lunglei

CHECKED BY

 (K. LALCHANDAMMA)
 Surveyor - I
 Land Revenue & Settlement Dept
 Lunglei District, Lunglei

APPRO

**BOUNDARY DESCRIPTION OF COMPENSATORY AFFORESTATION
FOR 460MW KOLODYNE HYDRO POWER PROJECT AT
MAUSEN : LUNGLEI DISTRICT**

LOCATION : Mausem VC area, Lunglei to Aizawl kawng thlang Leiten ram Saipui lui kam, Uikhinga lui leh Leiten lui inkar.

ST.POINT : A area chhimchhak lam kil kawngpui atanga 30.00m a hla Uikhinga lui kawr atanga 10.00m a hla ah P.No.1 na phun a ni a, teh tan nan hman a ni.

P.No.1-5 : Tehtanna P.No.1 na atangin 352° in a kal a, 310.00m pt ah P.No.2 na phun leh a ni. P.No.2 na atangin 12° in a kal leh a 4.00m pt ah P.No.3 na phun leh a ni. P.No.3 na atangin H.Lalnunpuia ram riin 288° in a kal leh a, 250.00m pt ah P.No.4 na phun leh a ni. P.No.4 atangin H.Lalawmpuia bawk riin a kal a, 353° in a kal leh a, 300.00m pt ah Leiten lui bul ah P.No.5 na phun a ni.

P.No.5-8 : P.No.5 na atang chuan Leiten lui kawr kam zelah ramri chu 260° in a kal leh a, 450.00m Sd, 349.71m Hd pt ah P.No.6 na phun leh a ni. P.No.6 na atangin 272° in a kal leh a, 520.00m Sd, 454.80m Hd pt ah P.No.7 phun leh a ni. P.No.7 na atangin 258° a kal leh in 320.00m Sd, 255.56m Hd pt ah P.No.8 na phun leh nghal a ni.

P.No.8-10 : P.No.8 na atangin Saipui lui kam zelah chhovin 166° in a kal leh a, 460.00m pt ah P.No.9 na phun a ni. P.No.9 na atang chuan 170° in a kal leh a, 380.00m pt ah P.No.10 na phun a ni.

P.No.10-1 : P.No.10 na atangin ramri chu Uikhinga lui zawh chhovin, 89° in a kal leh a, 330.00m Sd, 299.08m Hd pt ah P.No.11 na phun leh a ni. P.No.11 na atangin 106° in a kal leh a, 510.00m Sd, 407.30m Hd pt ah P.No.12 na phun leh a ni. P.No.12 na atang chuan 91° in a kal leh a, 530.00m Sd, 393.86m Hd pt ah a tira teh tanna P.No.1 na kha a man leh chiah a ni.

A area pumpui chu 1008594.37 Sqmt = 10852475.42 Sqft = 753.64 Bigha=100.85

Ha a ni.

Demarcated by K.Lalmachhuana Surveyor Land Revenue & Settlement Lunglei District : Lunglei	Checked by K.Lalchhandama Surveyor - I Land Revenue & Settlement Lunglei District : Lunglei	Countersigned by Lalthansiamia Asst. Survey Officer Land Revenue & Settlement Lunglei : Mizoram.	Approved by
--	---	--	-------------

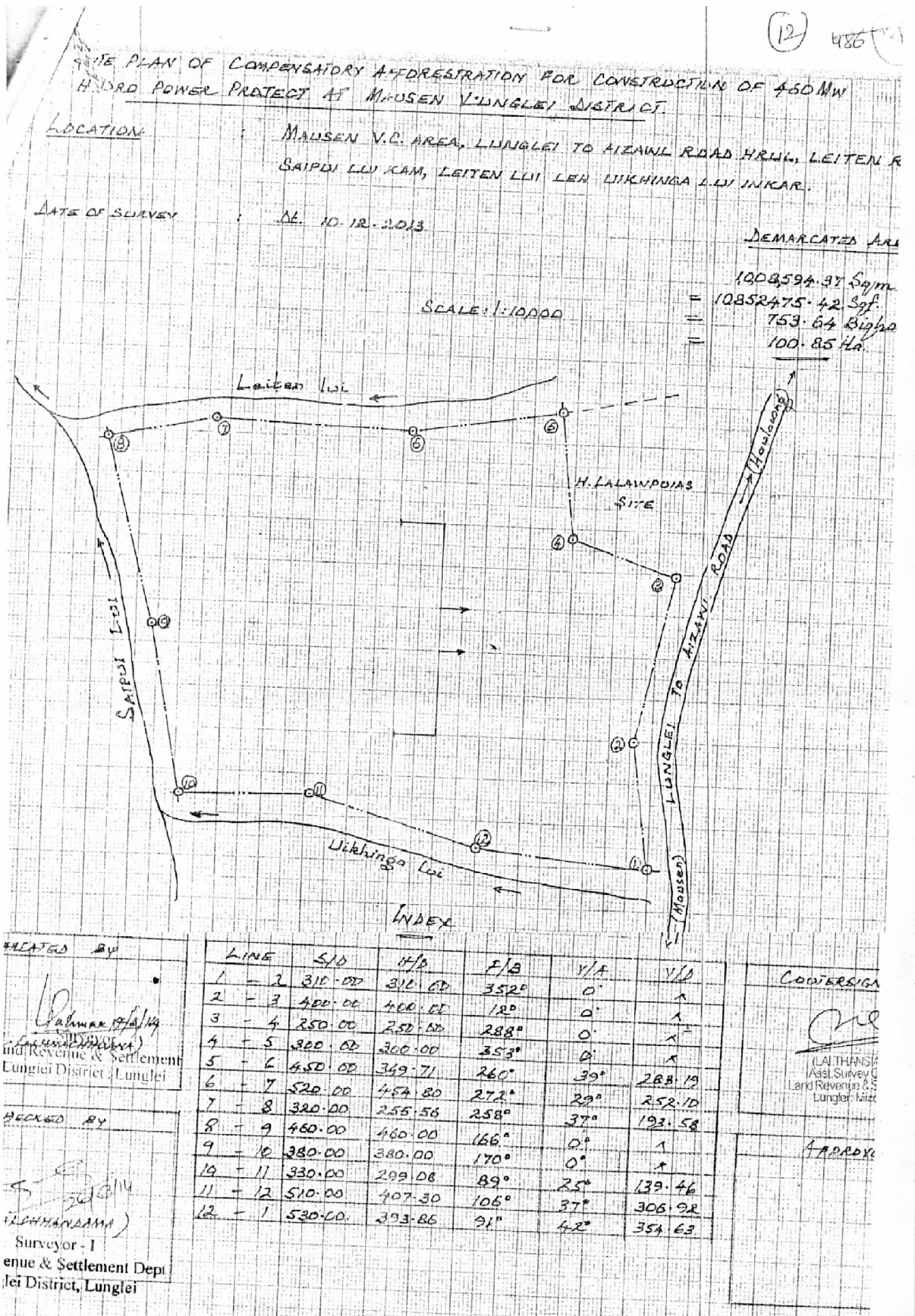

**BOUNDARY DESCRIPTION OF COMPENSATORY AFFORESTATION
FOR 460MW KOLODYNE HYDRO POWER PROJECT AT
SOUTH VANLAIPHAI : LUNGLEI DISTRICT**

- LOCATION : South Vanlaiphai VC area Pakunga hmun kham hnuai Tlangkhang kawng hmar lam.
- ST.POINT : A ram hmarchhak lam kil, Thingthupui kawn, Thingthupui thing bulah P.No.1 na phun a ni a, teh tan nan hman nghal a ni.
- BP.No.1-2 : Teh tanna sawi BP.No.1 na atangin Tlangkhang kawng hrulah 195° in a kal a, 530.00m pt ah PB No.2 na phun a ni.
- BP.No.2-3 : BP.No.2 na atangin Tlangkhang kawng hrulah 277° in a kal leh a, 1100.00m Sd, 942.99m Hd pt ah BP.No.3 na phun leh a ni.
- BP.No.3-4 : BP.No.3 na atangin kawrte dung zawhin 15° in ramri chu a kal leh a, 540.00m pt ah BP.No.4 na phun leh a ni.
- BP.No.4-1 : Bp.No.4 na atangin kham ko zelah 97° in a kal leh a, 1100.00m Sd, 942.88m Hd pt ah teh tanna a man leh a ni.

A area pumpui chu 498200.00 Sqmt = 5360632.00 Sqft = 372.26 Bigha - 49.82 Ha a ni.

Demarcated by K.Lalmachhuana Surveyor	Checked by K.Lalchhandama Surveyor - I	Countersigned by Lalthansiamama Asst. Survey Officer	Approved by
Land Revenue & Settlement Lunglei District : Lunglei	Land Revenue & Settlement Lunglei District : Lunglei	Land Revenue & Settlement Lunglei : Mizoram.	

PROPOSED SITE PLAN FOR COMPENSATORY AFFORESTATION FOR
CONSTRUCTION OF 460 MW KALDYNE HYDRO POWER PROJECT
AT SOUTH VANLAPHAI LUNGLEI DISTRICT.

LOCATION : SOUTH VANLAPHAI V.G. AREA, PAKLINGA MUMU KHAM HAWA,
TLANGKHANG KAWING HMAR LAM.

DATE OF SURVEY : 26.12.2013.

SCALE : 1 : 10000

AREA
498200.00m²
= 5260632.00p²
= 372.26 Bighas
= 49.32 Ha

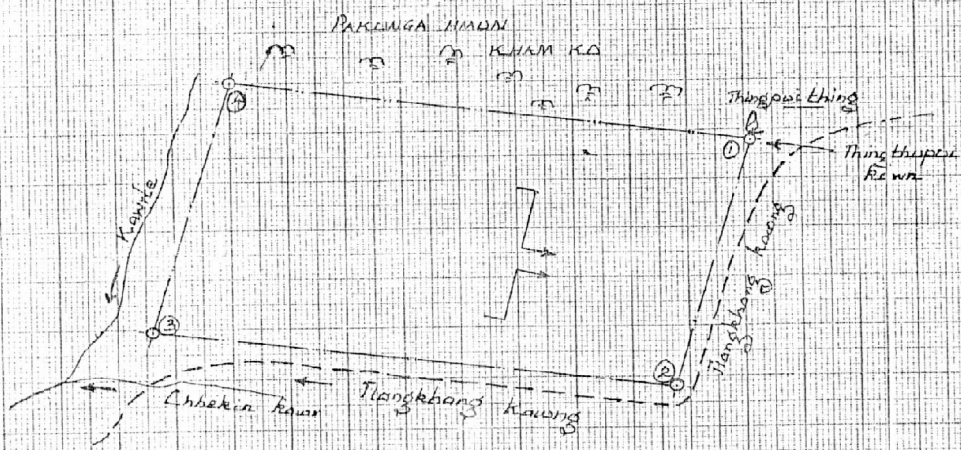

TABLE

LINE	SLD	H/D	F/B	V/A	V/D
1 - 2	530.00	530.00	19.5°	0°	x
2 - 3	1100.00	942.88	277°	31°	566.52
3 - 4	540.00	540.00	15°	0°	x
4 - 1	1100.00	942.88	97°	31°	566.52

DEMARKATED BY	CHECKED BY	COUNTERSIGNED BY	APPROVED
 K. LALCHUANTHANA Land Revenue & Settlement Lunglei District: Lunglei	 K. LALCHUANTHANA Surveyor - I Land Revenue & Settlement Dept Lunglei District: Lunglei	 K. LALCHUANTHANA Asst. Survey Officer Land Revenue & Settlement Lunglei: Mizoram	